

TOPOGRAPHIC SURVEY
 BEING PART OF THE MEDICAL UNIVERSITY OF
 OHIO, OUTPATIENT SURGERY CENTER
 PREPARED FOR D.G.L. CONSULTING ENGINEERS
 AT THE REQUEST OF MR. GARY LONG

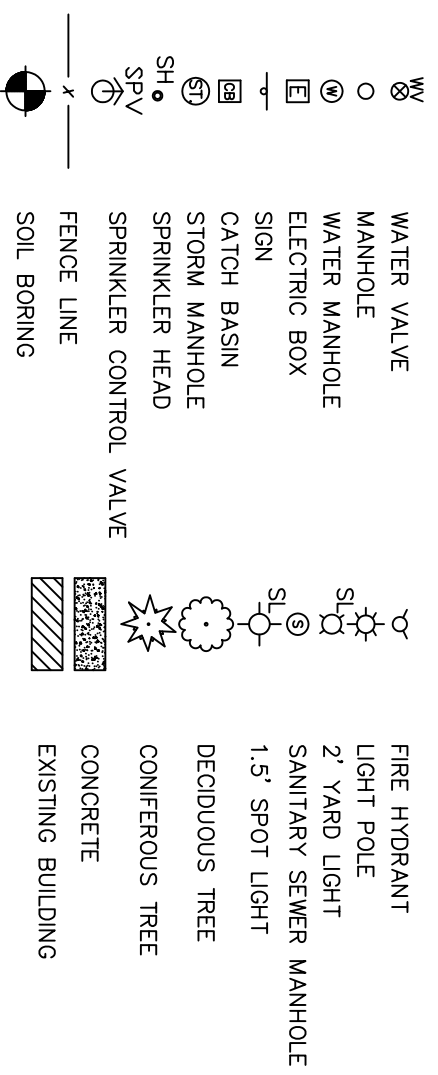

- NOTES:**
- APPROXIMATE LOCATION OF UNDERGROUND UTILITIES AS SCALED FROM PLANS PREPARED BY SAMBORN, STEKETEE, OTIS AND EVANS, INC., TITLED UTILITY PLAN FOR THE MEDICAL COLLEGE OF OHIO AND HAVING A REVISION DATE OF 11-29-80.
 - APPROXIMATE LOCATION OF UNDERGROUND UTILITIES AS SCALED FROM PLANS PREPARED BY SAMBORN, STEKETEE, OTIS AND EVANS, INC., TITLED UTILITY PLAN FOR THE MEDICAL COLLEGE OF OHIO AND HAVING A REVISION DATE OF 8-16-00.
 - APPROXIMATE LOCATION OF UNDERGROUND ELECTRIC LINES AS SCALED FROM A SKETCH PROVIDED BY MR. MIKE GAYTON, M.U.O., AS RECEIVED ON 7-22-05.
 - VERTICAL DATUM BASED ON THE PLANS FOR THE WIDENING OF HOSPITAL DRIVE AT THE INTERSECTION OF ARLINGTON AVENUE, HAVING A REFERENCE BENCHMARK LOCATED AT STATION 4+85.89, 4.37' IN CHISEL "SQUARE" IN THE NORTH SIDE OF THE CONCRETE BASE FOR THE LIGHT POLE. THE REFERENCE BENCHMARK HAVING AN ELEVATION = 624.98.
 - FOR SOIL BORINGS 1 & 2, (X,Y,Z) COORDINATES WERE REQUESTED BY D.G.L. CONSULTING ENGINEERS. SOIL BORING #1 (5005.6756, 4999.2533, 624.60) SOIL BORING #2 (5005.6759, 4999.2614, 624.61)
 - SITE BENCHMARK CHISELED "X" IN CONCRETE ON LIGHT POLE BASE. ELEVATION = 623.23
 - SITE BENCHMARK CHISELED "X" ON SOUTH CORNER BOLT OF FIRE HYDRANT. ELEVATION = 627.43.

STRUCTURE LIST:

- CB
 RIM=622.95
 INV(N)=619.75
- SSMH
 RIM=624.08
 INV(N)=601.08
 INV(S)=600.98
- SSMH
 RIM=624.90
 INVERTS, PIPE
 SIZES AND
 IDENTIFIABLE
- STMH
 RIM=626.90
 INV(E)=620.30
 INV(SW)=619.90
- CB
 RIM=623.70
 INV(N)=619.90
 INV(E)=619.80
 INV(W)=619.80
- STMH
 RIM=626.98
 INV(S)=619.78
 INV(NW)=617.18
- CBM
 RIM=623.75
 INV(N)=620.45
- CBM
 RIM=623.66
 INV(W)=620.06
- MMH
 RIM=624.49
- CB
 RIM=616.74
 INV(W)=614.54
- CB
 RIM=623.39
 INV(S)=619.79
- CB
 RIM=623.59
 INV(E)=620.19
 INV(W)=620.59
- CB
 RIM=624.00
 INV(W)=620.80

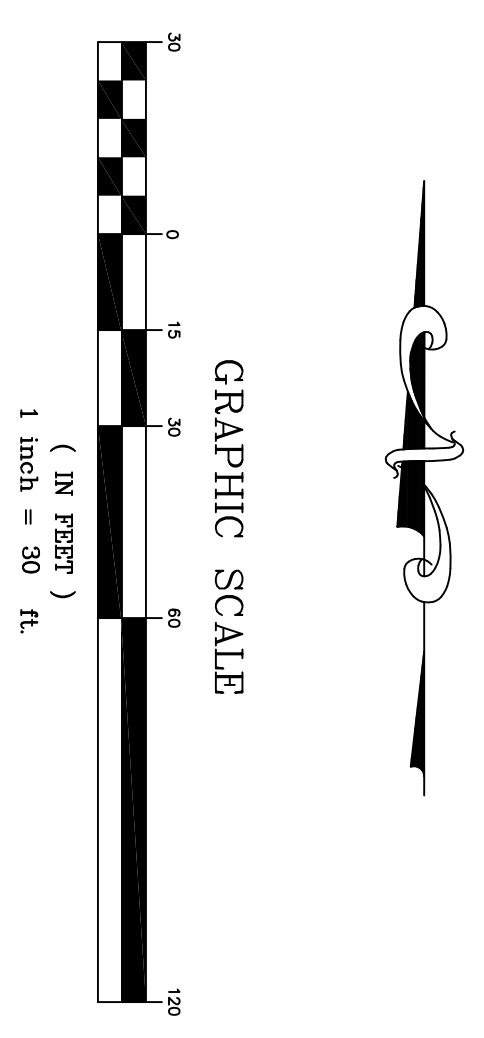
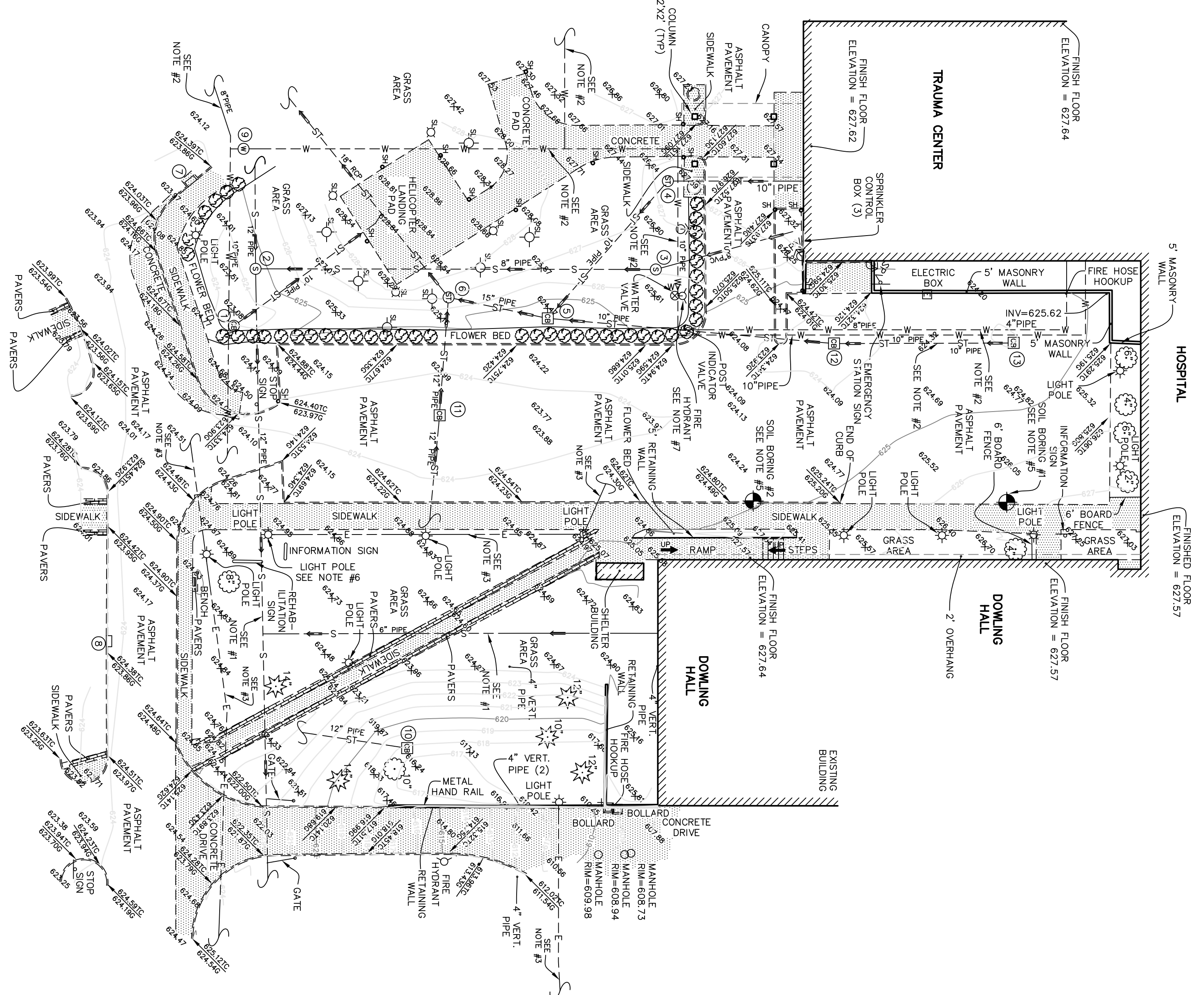

NOTE:
 I HEREBY CERTIFY THAT TO THE BEST OF MY KNOWLEDGE, THE INFORMATION AND BELIEF, OF ALL INFORMATION SHOWN HEREON IS TRUE, AND ACCURATE PERFORMED UNDER MY SUPERVISION DURING AUGUST, 2005.

Anthony A. Garcia
 Professional Surveyor No. 8112
 Date _____

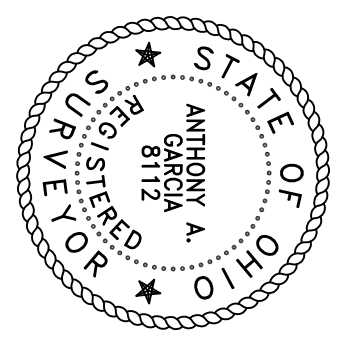

Saneholtz & Associates, LLC
 P.O. Box 2628 Whitehouse, OH 43571
 Phone: (419) 677-0400
 Fax: (419) 677-1140
 Mobile: (419) 350-8618
 E-Mail: ss@saneholtz.com

Saneholtz & Associates, LLC
 P.O. Box 964 Bryan, OH 43506
 Phone: (419) 636-5828
 Fax: (419) 636-5838
 Mobile: (419) 438-2666
 E-Mail: pj@saneholtz.com

REV.	DESCRIPTION	BY	DATE
1	ADD F.F. GRADES & ROTATE DWG	AJT	08/10/2005

JOB NAME:	MUO TOPOGRAPHIC SURVEY	JOB NUMBER:	051500853
CLIENT NAME:	DGL	SCALE:	1" = 30'
DESCRIPTION:	TOPOGRAPHIC SURVEY	DATE:	08/04/05
		CLIENT TICKET NUMBER:	
		DRAWN BY:	AJ/TAG
		CHECKED BY:	TAG
		DRAWING NAME:	SHEET
			1 of 1